

**The only luxury motor yacht
built like a high performance sportfisherman.**



**VIKING 44'
MOTOR YACHT**



The "large yacht" salon with a step-down galley/dinette.



THE INTEGRATION OF THE SALON WITH A GALLEY/DINETTE DOWN DESIGN CREATES A WIDE OPEN, SOPHISTICATED ENTERTAINING AREA.



THE 126 SQ. FT. AFT DECK ENTERTAINMENT AREA COMPLETE WITH WET BAR AND OPTIONAL HARDTOP.



THE SPACIOUS WALK-AROUND, QUEEN-SIZED BED AND TEAK BUREAUS OF THE LUXURIOUS AFT MASTER SUITE.



THE EURO-STYLE GALLEY FEATURES TOUCH-RELEASE CABINERY AND ALL THE LATEST APPLIANCES.



The 44's structural integrity begins with fiberglass technology not found on other yachts. As the hull is laminated, each cured layer is sanded smooth. While this is time consuming and costly, it's the only way to maximize adhesion in the laminate. These carefully engineered laminates then are backed up with Viking's exclusive hull reinforcement system. First the keel and reverse chines are filled with a resin silica compound to add rigidity. Not satisfied with glass encapsulated bulkheads and longitudinals alone, Viking engineered an eggcrate-like grid of cant strip stiffeners where the bulkheads and stringers intersect. This solid grid reinforces the hull's strength by spreading loads evenly through the hull without adding excessive weight.

Instead of the usual practice of attaching their engines to longitudinal stringers, each engine on the 44' is mounted to a pair of wide, flanged steel beams and then fastened to dedicated bulkheads fore and aft. This system not only distributes engine loads evenly; it actually *strengthens* the hull.

To ensure uniform quality,

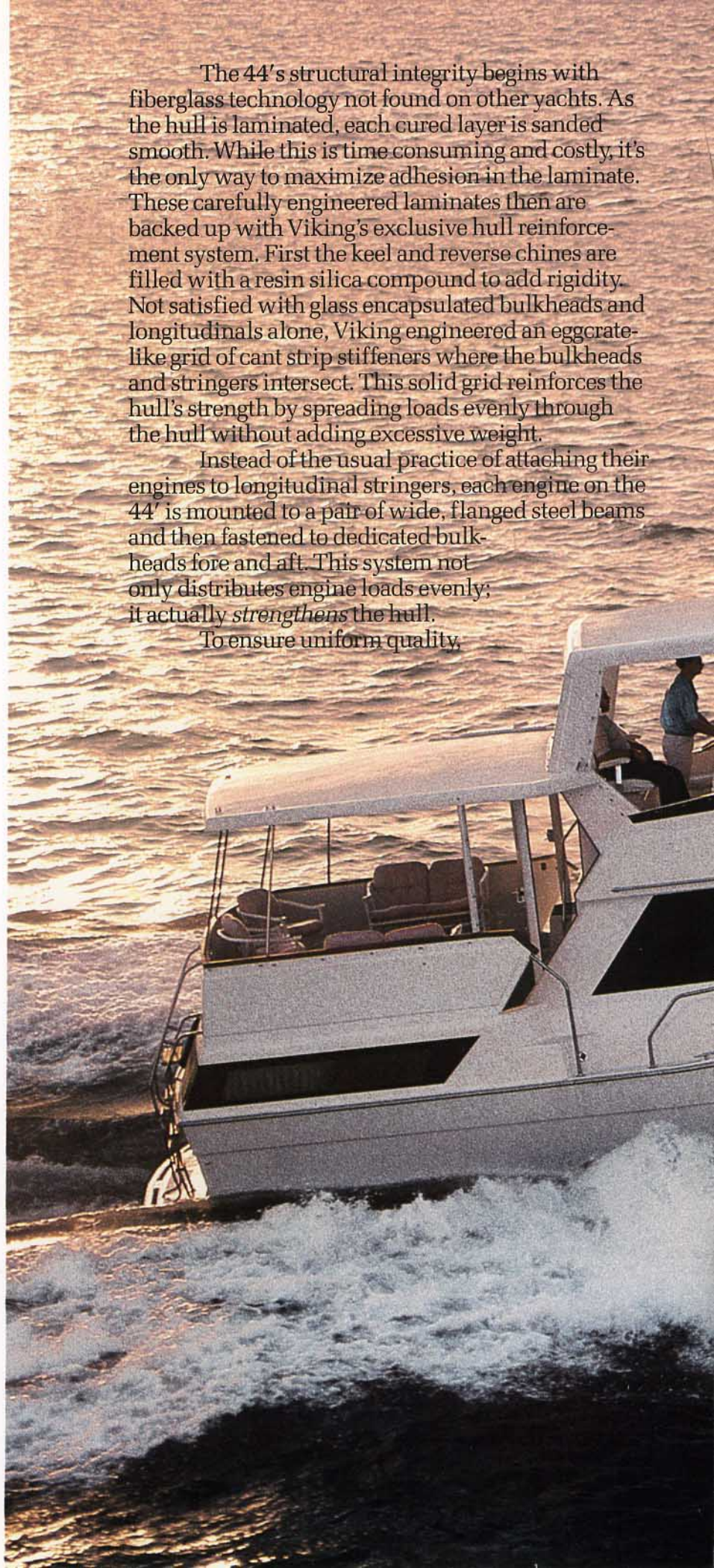

THE DINETTE LETS YOU FEED THE ENTIRE CREW IN ONE SEATING.

THE GUEST STATEROOM TWIN BUNK OPTION SHOWN WITH ITS PRIVATE HEAD.

exact fit and flawless operation, metalwork (rails, doors and window frames), fiberglass components (tankage and optional hardtop) and all cabinetry are created exclusively in-house.

The huge bridge and aft deck double your entertaining space.

The 44's contemporary layout brings large yacht luxury, comfort and convenience into the mid-length range. The open aft deck equipped with wet bar allows passengers to see fully about the boat, creating an open, airy feel. The flybridge is equally well-designed, featuring generous seating, an expansive helm console for flushmounting of electronics and clear 360-degree visibility.

Just a few steps down is a massive interior that integrates the salon, dinette and galley into a sophisticated open, entertaining area. Throughout, fine hand-crafted interiors of rich teak, custom-tailored decorator accents and built-in conveniences bespeak luxury and good taste. The L-shaped lounge and low profile stereo and TV/VCR not only save space; they enhance the decor. Two steps down, the capacious portside dinette lets you serve all in one seating. The Euro-style galley to starboard features modern, touch-release cabinetry, an all-electric range, a full-size refrigerator, and a microwave/conventional oven.

An optional hi-lo washer and dryer are housed in the companionway locker. Forward, the guest suite is available with walk-around double bed or twin bunks, served by a full-sized guest head.

The private master suite is yet another example of craftsmanship that shows, even down to a grain-matched teak. An entertainment center, hanging cedar lockers, bureau storage and private head enhance the sensation of luxury and relaxation.

With the Viking 44', you satisfy your need for both speed and luxury. So, before you consider any mid-size motor yacht, spend a few moments with the Viking 44' — it could save you a lot of time later on.



THE PROFESSIONAL HELM PROVIDES PLENTY OF ROOM FOR FLUSH MOUNTING ELECTRONICS (AND SEATS, BY THE WAY).

On a Viking, with speed comes strength.

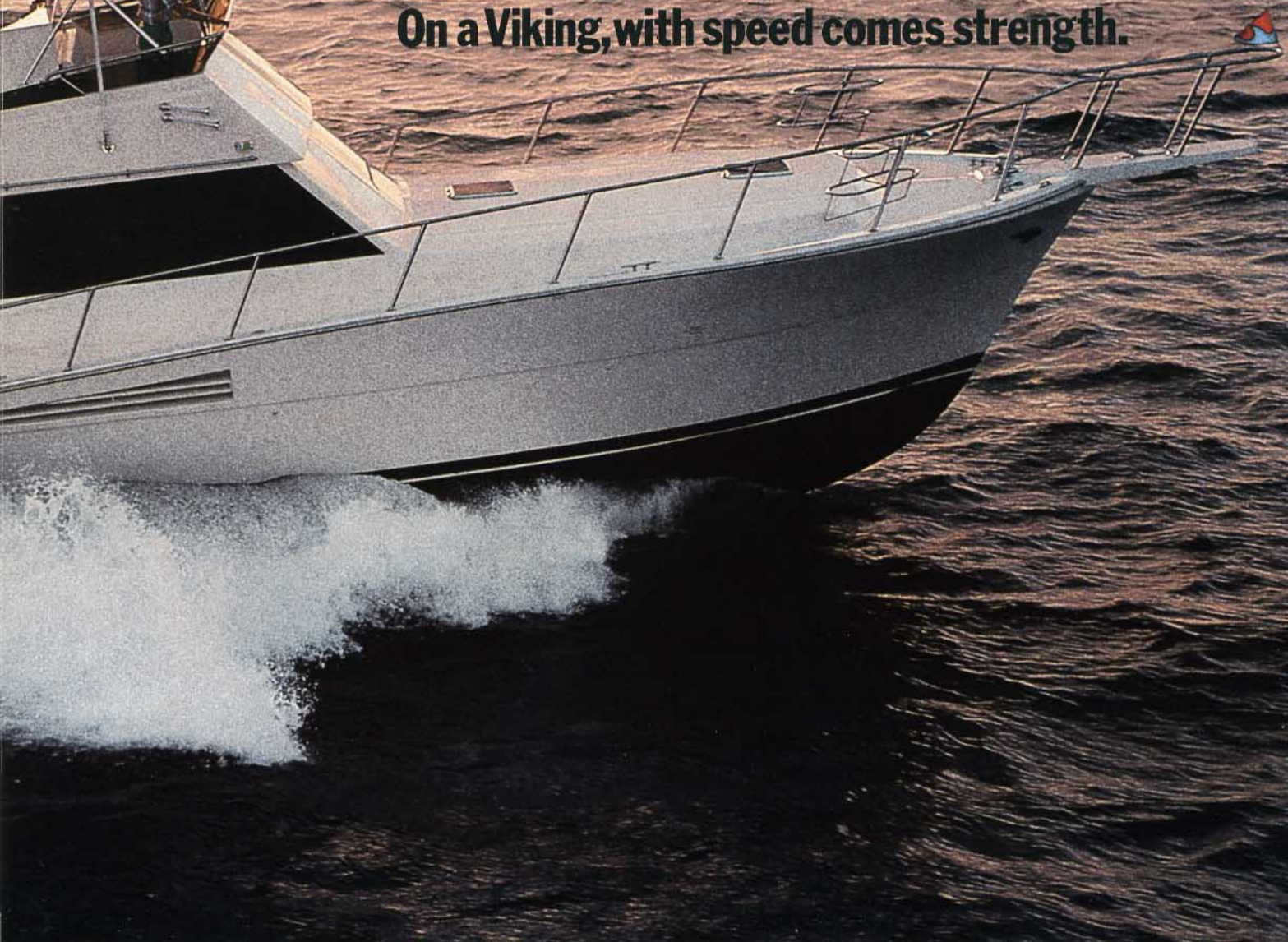

If you've reached the station in life when you're ready for a yacht of this caliber, you're well aware of the fact that time is money. So, consider this: an extra four or five knots cruising speed does a lot more than win races. You can tarry longer at your turnaround point, play more with your water toys or just plain relax. Weekends seem longer, and in a sense they are, when you don't spend all your time just getting there. But, time is more than money; it's life itself. The Viking 44' puts more of it at your disposal—to spend any way you want.

At Viking, the definition of luxury includes speed.

With a length two to four feet longer than the competitors' boats, this Viking neatly bridges the gap between mini-motor yachts and their bigger brethren. This extra length gives the 44' an important feature—a genuine motor yacht-sized engine room. Instead of a pair of gas engines struggling to develop 600 hp, Viking provides a pair of turbocharged diesels that crank out nearly 1000 hp—without even breathing hard. These are the same engines that consistently power Viking sportsfishermen past the front of the pack at tournaments worldwide.

Despite her aggressive profile and crisp styling, the 44's entertaining talents are obvious the first time you lay eyes on her at the dock. Two great venues for entertaining—the 126-square foot aft deck and the bridge—are just two steps apart. Optional hardtops can be specified for either or both, greatly increasing the 44's open-air, indoor/outdoor entertainment area. With its efficient interior layout, the 44' offers the accommodations, privacy and entertainment capabilities of a far larger yacht. Entertaining is not limited to dockside; rather, her speed, acceleration and responsiveness makes an impressive presence underway, as well.

Built to the same bluewater standards as all Vikings, the 44' has the same efficient (and fast) underbody. The crisp forefoot slices through chop to allow the unique Viking aft planing fairbody to get to work. And work it does: this exclusive hull design gives the 44' enough speed to eat the competition for breakfast. And that includes convertibles, too.

**The 44' makes an equal impression
at rest or underway.**



VIKING 44' MOTOR YACHT

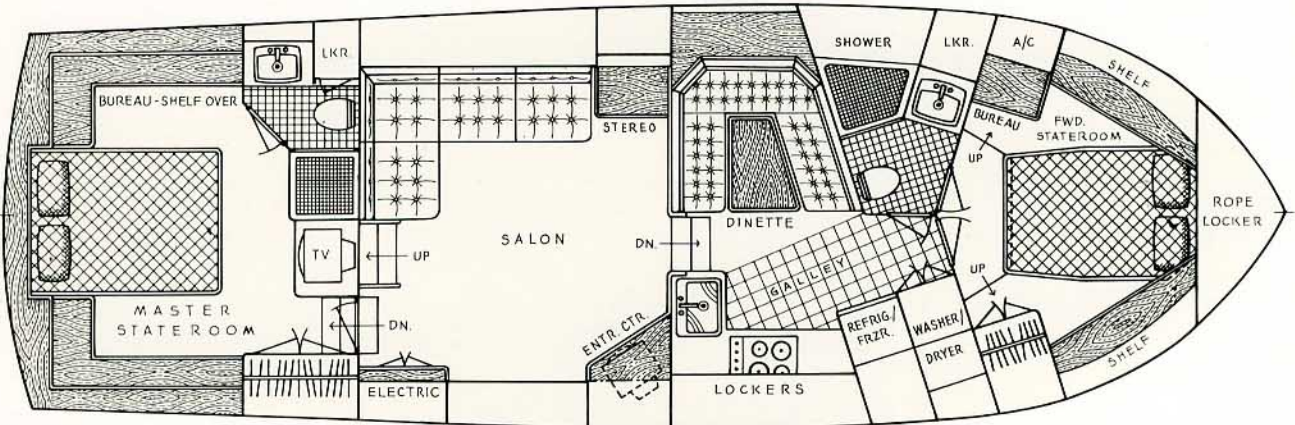

FORWARD STATEROOM (Double Berth) MODEL—PLAN A

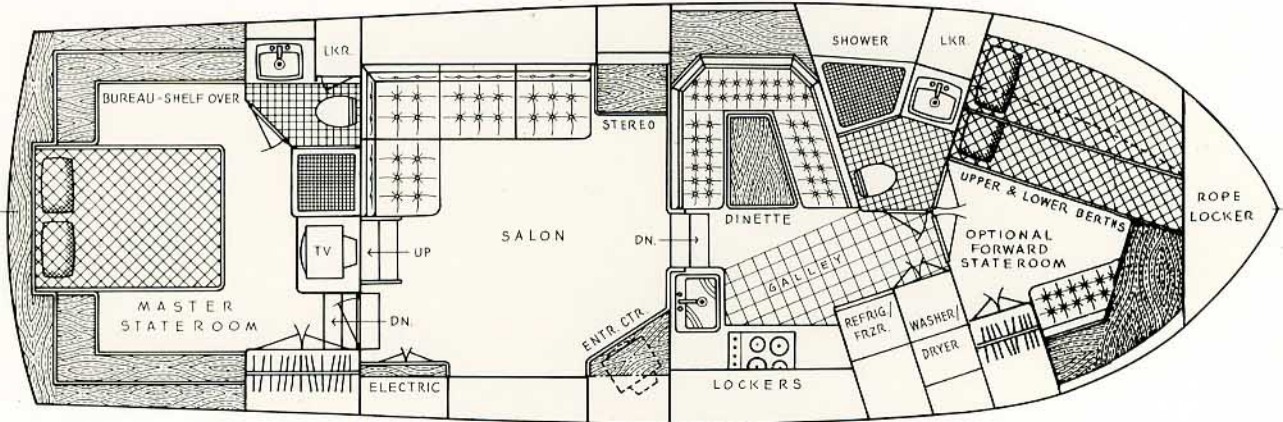

FORWARD STATEROOM (Upper/Lower Bunks) MODEL—PLAN B



viking
yachts

Where luxury
assumes new meaning.

Viking Yachts, Route 9 and the Garden State Parkway, New Gretna, NJ 08224, (609) 296-6000 Fax (609) 296-3956

The right is reserved to make changes, without notice, at any time, in equipment, materials, prices and specifications. Line drawings and photos may show some optional equipment.